



## INTER-OFFICE MEMORANDUM

### Prince George's County Fire/EMS Department

**PGFD**

October 6, 2004

**To:** All Fire Department Personnel

**From:** Kirk Souder, Captain, Station 5  
Fire and Rescue Operations

**RE:** New Maps for Company 5

The new maps for Company 5's first due area are completed and being distributed to all Companies who need a copy. The following information may be helpful with the explanation of the new format. Please call me at Company 5 if you have any questions.

- The indexes include hundred blocks, cross streets, street maps, box maps, and building names or complex names. Schools and Churches are also listed.
- The Box Areas map shows the box areas in Company 5's area and the dispatch order for all of 5's box areas.
  - The Overview of the first due area shows the number of the respective street map page over each of the 10 map page areas.
  - The Street Maps cover all streets, hydrants, and buildings. All pages are oriented with North being toward the top. All streets and buildings are proportional and drawn directly over an aerial view. Landing Zones are denoted by an "LZ" and the corresponding ADC map page number under each LZ to be used as information for the helicopters.
  - The Box Maps numbers correspond to the street maps. For example, every box map on Street Map page 8 would be 8A, 8B, etc. Some box maps display only the building floor plan. For example, Box Map 8A shows the floor plan for 505 Suffolk Avenue. For a view of the streets, hydrants, and access, refer to Map 8. Box Maps with the word "KEYS" under the map number denote the complexes and buildings for which Company 5 has keys. All Box Maps have a scale showing the distance between two points on the map. This will denote distances in relation to streets, hydrants, etc. or it will show dimensions of a building
  - The maps work best if all street maps are kept together (1-10) and then all box maps are kept together (1A-10A).
  - It is important to start the Street Maps with Page 1 and Page 2 in the same sheet protector so that when the book is open, Maps 2 and 3 are paired up, 4 and 5 are paired up, and so on.

**COMPANY**

**5**

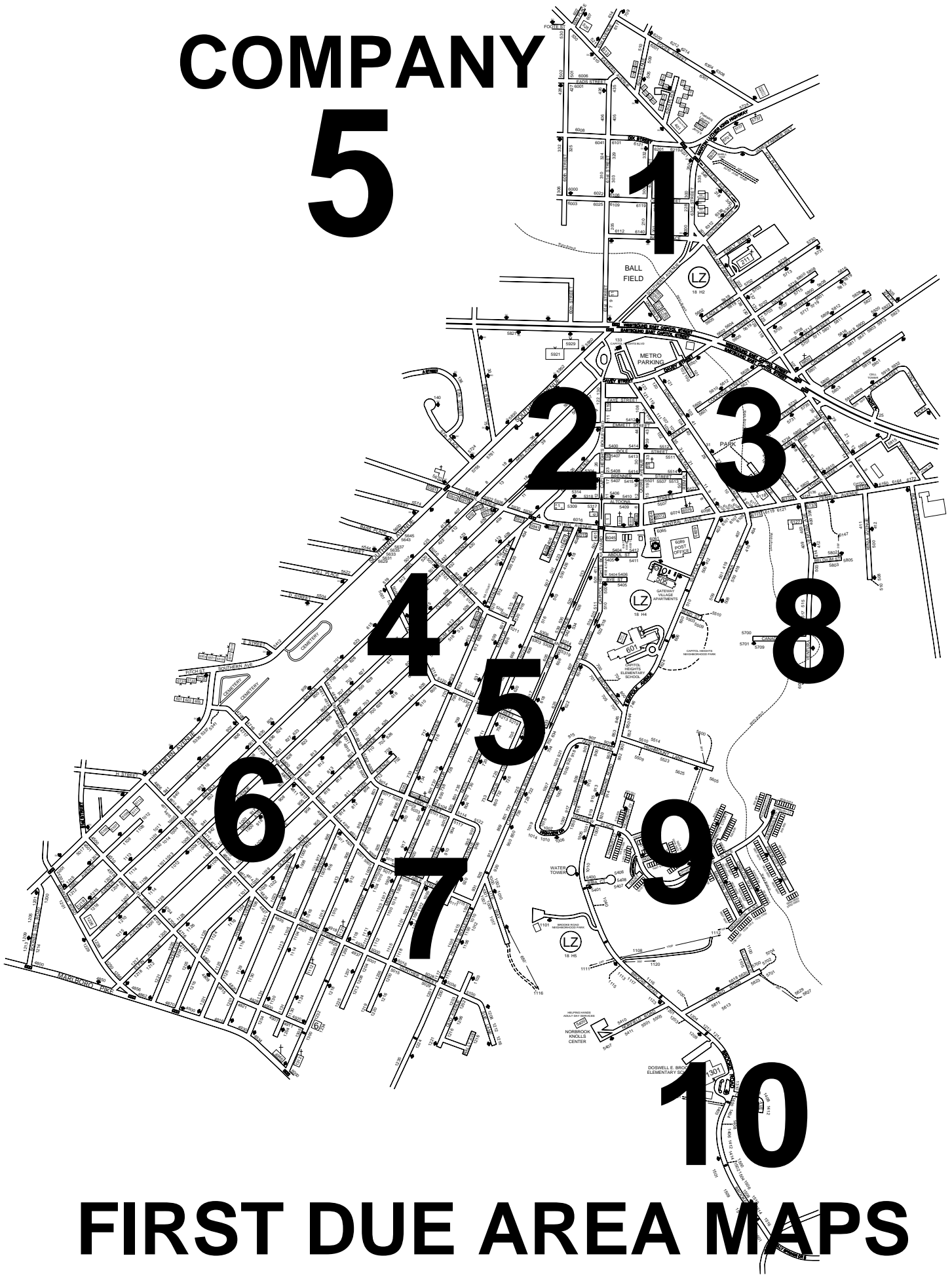

**FIRST DUE AREA MAPS**

# COMPANY 5

- 5-1 5,8,17,38,26,22,37,29,33,23
- 5-2 5,8,17,38,26,22,37,29,33,23
- 5-3 5,8,38,17,26,37,22,29,33,46
- 5-4 5,8,38,17,26,37,22,33,46,29
- 5-5 5,17,8,26,38,29,22,37,23,33
- 5-6 5,8,38,17,26,22,33,37,29,9
- 5-7 5,26,8,17,38,23,37,29,22,33
- 5-8 5,8,26,17,38,37,22,23,29,33
- 5-9 5,8,38,17,22,26,33,37,9,30
- 5-10 5,8,38,17,22,33,26,37,30,9
- 5-11 5,17,8,26,38,29,22,37,23,33

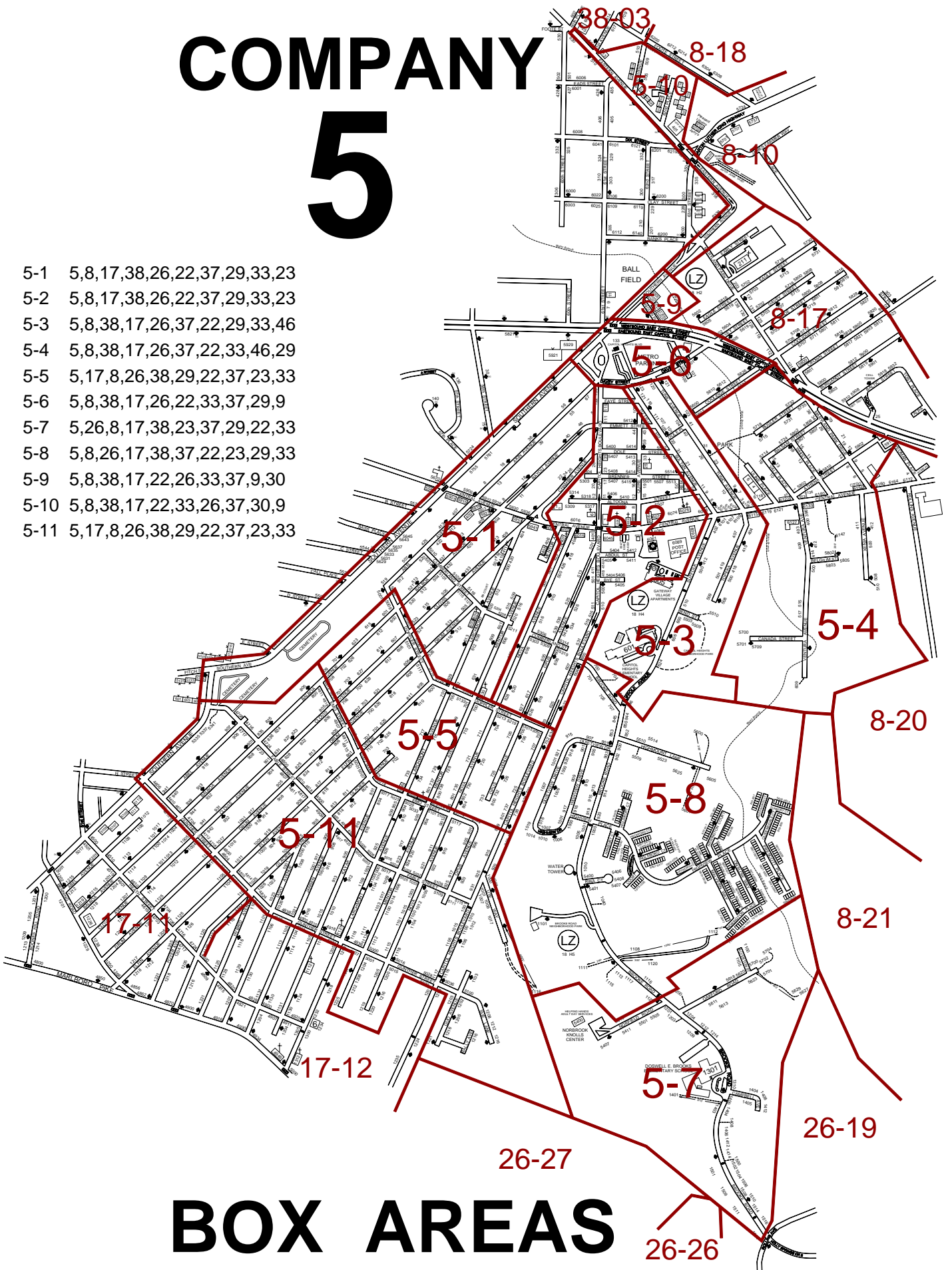

# BOX AREAS

# A - B

<b>STREET NAME</b>	<b>BLOCK / Cross Street</b>	<b>STREET MAP</b>	<b>BOX MAP</b>
ABDUL STREET	5400 Capitol Heights Boulevard	5	
ABEL AVENUE	400-500 Central Ave. - Doppler St.	4	
ABEL AVENUE	900 Fable St. - Gunther St.	6	
AKIN AVENUE	UNIT Central Ave. - Davey St.	2	
ALTOONA STREET	5300-5500 Capitol Heights Blvd. - Sultan Ave.	2	
ALVERTON STREET	1100 Oakford Road	10	
ATHENA STREET	5800-5900 Vale Pl. - Yeoman Pl.	3	
BALBOA AVENUE	400-700 Central Ave. - Emo St.	4	
BALBOA AVENUE	800-900 Emo St. - Gunther St.	6	
BALSAM STREET	5700-5800 Vale Pl. - Maryland Park Dr.	3	
BAYOU AVENUE	UNIT Central Ave. - Capitol Heights Blvd.	2	
BELGIUM STREET	5800 Ventura Avenue	8	
BEND STREET	5500 Suffolk Avenue	8	
BRENNER STREET	5300-5500 Capitol Heights Blvd. - Rem Pl.	2	
BROOKE ROAD	700-1100 Capitol Heights Blvd. - 1100 blk.	9	
BROOKE ROAD	1100-1500 1100 blk. - Rollins Ave.	10	
BROOKE ROAD Doswell E. Brooks Elementary	1301 Campbell Avenue	10	10A
BUGLER STREET	5700 Maryland Park Drive	3	
BYE STREET	5400 Capitol Heights Boulevard	5	

# C - D

<b>STREET NAME</b>	<b>BLOCK /</b> Cross Street	<b>STREET MAP</b>	<b>BOX MAP</b>
CAMPBELL AVENUE	1400 Brooke Road	10	
CANADA STREET	5700 Ventura Avenue	8	
CAPITOL HEIGHTS BLVD.	UNIT-100 Central Ave. - Davey St.	2	
CAPITOL HEIGHTS BLVD. Capitol Heights Metro Station	133 Davey Street	2	2A
CAPITOL HEIGHTS BLVD.	400-800 Central Ave. - 800 blk.	5	
CAPITOL HEIGHTS BLVD.	800-1000 800 blk. - Gunther St.	7	
CENTRAL AVENUE	5900-6061 Southern Ave. - Station 5	2	
CENTRAL AVENUE	6061-6150 Station 5 - Maryland Park Dr.	3	
CHAMBER AVENUE	UNIT Central Ave. - Capitol Heights Blvd.	2	
CLOVIS AVENUE	400-700 Larchmont Ave. - Emo St.	4	
CLOVIS AVENUE	800-900 Emo St. - Gunther St.	6	
COOLIDGE STREET	5600 East Capitol Street	3	
CUMBERLAND STREET	5000-5200 Abel Ave. - Mentor Ave.	4	
CUMBERLAND STREET	5300 Nova Ave. - Opus Ave.	5	
DAVEY STREET	5500 Southern Ave. - East Capitol St.	2	
DOLE PLACE	Sultan Ave. - Tunic Ave.	3	
DOLE STREET	5400-5500 Capitol Heights Dr. - Sultan Ave.	2	
DOPPLER STREET	5000-5100 Abel Ave. - Mentor Ave.	4	
DOPPLER STREET	5200-5300 Mentor Ave. - Capitol Heights Blvd.	5	
DRUM AVENUE	500-700 Cumberland St. - Emo St.	4	
DRUM AVENUE	800-900 Emo St. - Gunther St.	6	

# E - F - G

<b>STREET NAME</b>	<b>BLOCK / Cross Street</b>	<b>STREET MAP</b>	<b>BOX MAP</b>
EAST CAPITOL STREET	Southern Ave. - Davey St.	2	
EAST CAPITOL STREET	Davey St. - Maryland Park Dr.	3	
EASTERN AVENUE	401-525 MLK Hwy. - 60th Pl.	1	
EASTERN AVENUE Eastern Avenue Apartments	405-409 62nd Pl. - 62nd Ave.	1	1A
ELFIN AVENUE	600 Doppler St. - Emo St.	4	
ELFIN AVENUE	800-900 Emo St. - Gunther St.	6	
EMMETT STREET	5400-5500 Capitol Heights Blvd. - Sultan Ave.	2	
EMO STREET	4800-4900 Balboa Ave. - Elfin Ave.	4	
EMO STREET	5000-5100 Elfin Ave. - Opus Ave.	7	
FABLE STREET	4700-4900 Southern Ave. - Kayak Ave.	6	
FABLE STREET	500-5100 Kayak Ave. - Capitol Heights Blvd.	7	
FAYE STREET	5400 Capitol Heights Blvd. - Sultan Ave.	2	
GLACIER AVENUE	700-800 Emo St. - Fable St.	7	
GLACIER AVENUE	900-1000 Fable St. - Gunther St.	6	
GUNTHER STREET	4600-4800 Southern Ave. - Jansen Ave.	6	
GUNTHER STREET	4900-5000 Jansen Ave. - Capitol Heights Blvd.	7	

# H - I - J - K - L

STREET NAME	BLOCK / Cross Street	STREET MAP	BOX MAP
HACKFORD COURT	5400 Highview Place	9	9A
HANBURY COURT	1000 Highview Place	9	9A
HIGHMOUNT LANE	5500-5600 Brooke Road	9	
HIGHVIEW DRIVE	900-1000 Quietview Dr. - Quietview Dr.	9	
HIGHVIEW PLACE	Brooke Rd. - Sunbury Ct.	9	
HILLDROPT COURT	900 Highview Place	9	9A
HUNTSWORTH COURT	1000 Highview Place	9	9A
INGLEBORO COURT	5400 Highview Place	9	9A
JANSEN AVENUE	1000 Fable St. - Gunther St.	6	
KAYAK AVENUE	800-1000 Emo St. - Gunther St.	7	
KEYWORTH COURT	5500 Highview Place	9	9A
LARCHMONT AVENUE	400-700 Central Ave. - Emo St.	4	
LARCHMONT AVENUE	900-1100 Emo St. - Gunther St.	7	

# M-N-O-P

STREET NAME	BLOCK / Cross Street	STREET MAP	BOX MAP
MALVERN WAY	5600 Highview Pl. - Morington Pl.	9	9B
MARYLAND PARK DRIVE	UNIT Central Ave. - East Capitol St.	3	
MENTOR AVENUE	400 Central Avenue	5	
MENTOR AVENUE	500-700 Cumberland St. - Emo St.	5	
MENTOR AVENUE	900-1200 Emo St. - Gunther St.	7	
MORINGTON PLACE	1000-1100 Onslow Way - Malvern Way	9	9B
NEWINGTON COURT	900 Highview Place	9	9B
NORFIELD ROAD	5400-5500 Brooke Road	10	
NOVA AVENUE	400-800 Central Ave. - Emo St.	5	
NOVA AVENUE	900-1200 Emo St. - Gunther St.	7	
OAKFORD ROAD	5600-5700 Brooke Road	10	
ONSLow WAY	5600 Highview Pl. - Morington Pl.	9	9B
OPUS AVENUE	400-800 Capitol Heights Blvd. - Doppler St.	5	
OPUS AVENUE	900 Emo St. - Fable St.	7	
PRESCOTT PLACE	5600 Highview Place	9	9B

# Q - R - S

STREET NAME	BLOCK / Cross Street	STREET MAP	BOX MAP
QUEENSDALE COURT	800 Sunbury Ct. - Prescott Pl.	9	9B
QUIETVIEW DRIVE	900-1000 Brooke Rd. - Quietview Dr.	9	
QUIRE AVENUE	UNIT Central Ave. - Emmett St.	2	
QUO AVENUE	1200 Gunther Street	7	
RALLY AVENUE	1216 Quo Avenue	7	
REEDSWORTH COURT	800 Highview Place	9	9B
RIBA COURT	5400 Brooke Road	9	
REM PLACE	UNIT Altoona St. - Brenner St.	2	
SOUTHERN AVENUE	5300 Gunther St. - E St. SE	6	
SOUTHERN AVENUE	5600 E St. SE - Central Ave.	4	
SOUTHERN AVENUE	5700-5900 Central Ave. - East Capitol St.	2	
SOUTHERN AVENUE	6300 East Capitol St. - Eastern Ave.	1	
SUE LANE	1200 Gunther Street	7	
SUFFOLK AVENUE	400-700 Central Ave. - Brooke Rd.	8	
SUFFOLK AVENUE Gateway Village Apartments	505 Central Avenue	8	8A
SUFFOLK AVENUE Capitol Heights Elementary	601 Bend Street	8	8B
SULTAN AVENUE	UNIT-100 Central Ave. - Davey St.	3	
SUNBURY COURT	5600 Highview Place	9	9B

# T - U - V - W - X

STREET NAME	BLOCK / Cross Street	STREET MAP	BOX MAP
TOPEKA AVENUE	400-500 Central Avenue	8	
TUNIC AVENUE	UNIT-100 Central Ave. - Davey St.	3	
ULINE PLACE	UNIT Central Avenue	3	
UNICORN PLACE	200 Southern Avenue	1	
UREY PLACE	100 Davey Street	3	
UTE WAY	1000-1100 Capitol Heights Boulevard	7	
VALE PLACE	UNIT Central Ave. - Balsam St.	3	
VENTURA AVENUE	400-600 Central Avenue	8	
WHIST PLACE	UNIT Central Ave. - Balsam St.	3	
XENIA AVENUE	400-500 Central Avenue	8	









COMPANY  
MAP  
2

LZ  
18 H2

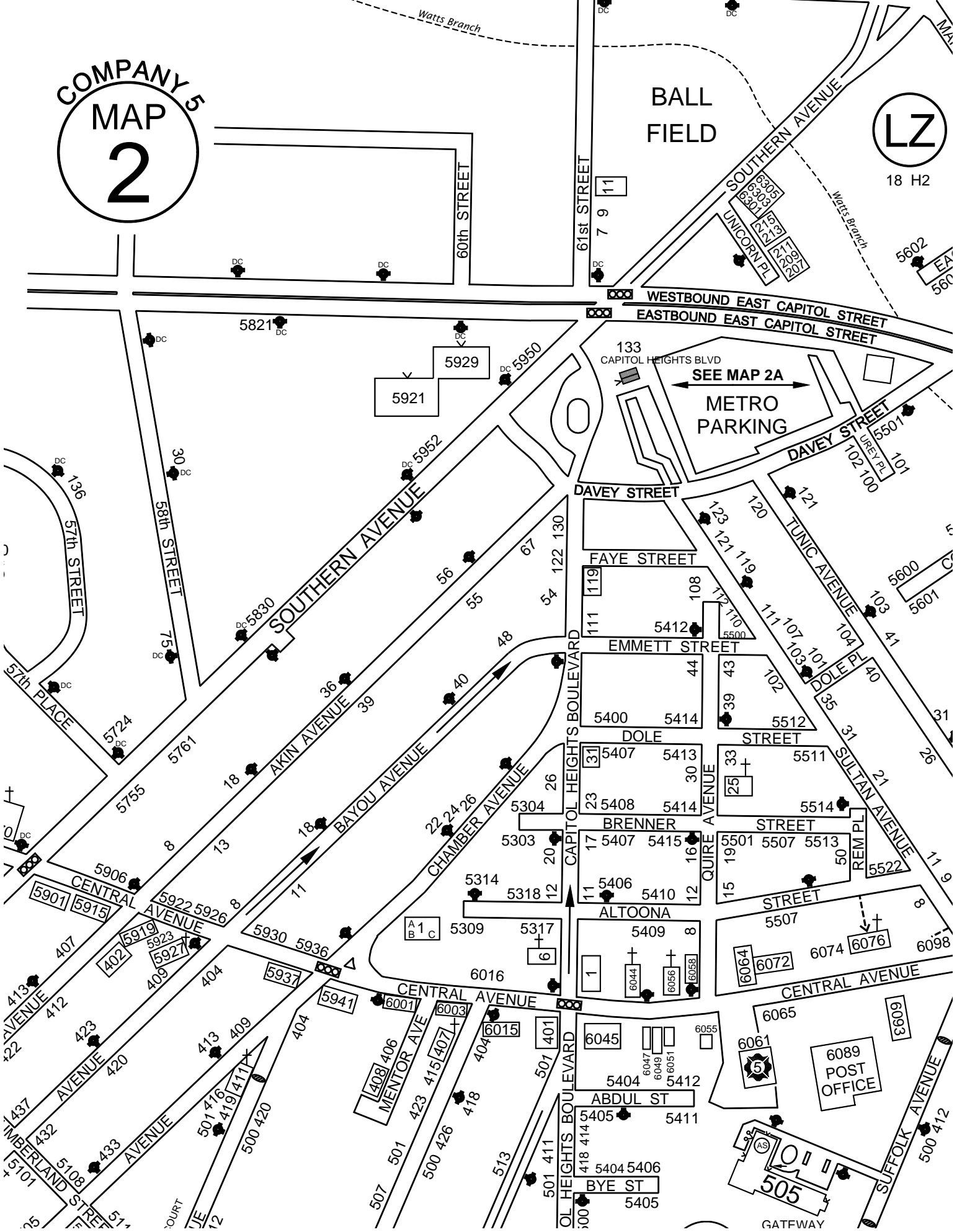

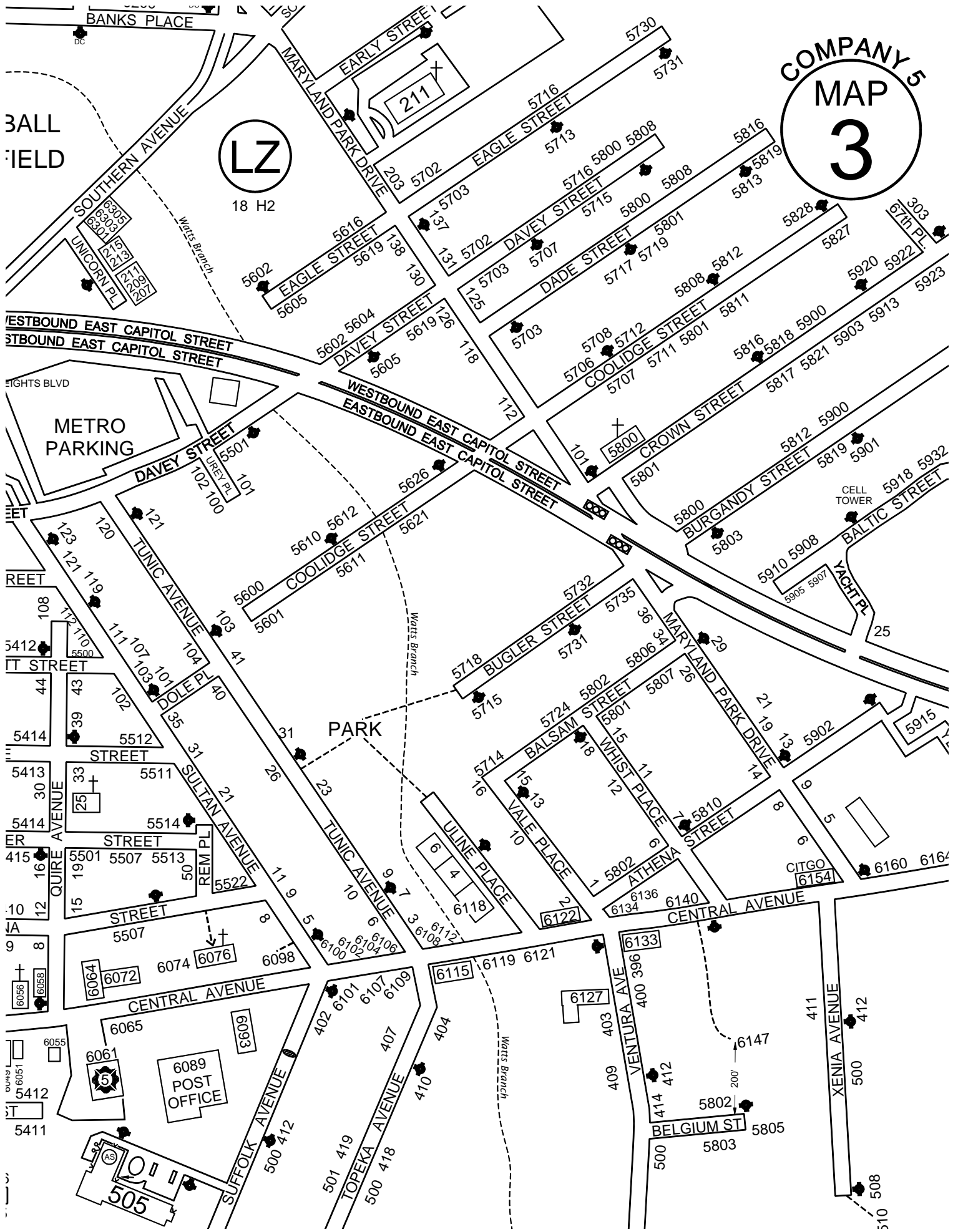

LZ  
18 H2

COMPANY 5  
MAP  
3

BALL  
FIELD

METRO  
PARKING

PARK

6089  
POST  
OFFICE

CELL  
TOWER

505

BANKS PLACE

SOUTHERN AVENUE

MARYLAND PARK DRIVE

EARLY STREET

211

EAGLE STREET

5716

5713

5702

5703

5702

5716

5800

5808

5813

5813

5816

5819

5813

5828

5812

5827

5827

5827

5827

5827

5827

5827

5827

5827

5827

5827

5827

5827

5827

5827

5827

5827

5827

5827

5827

5827

5827

5827

5827

5827

5827

5827

5827

5827

5827

5827

5827

5827

5827

5827

5827

5827

5827

5827

5827

5827

5827

5827

5827

5827

5827

5827

5827

5827

5827

5827

5827

5827

5827

5827

5827

5827

5827

5827

5827

5827

5827

5827

5827

5827

5827

5827

5827

5827

5827

5827

5827

5827

5827

5827

5827

5827

5827

5827

5827

5827

5827

5827

5827

5827

5827

5827

5827

5827

5827

5827

5827

5827

5827

5827

5827

5827

5827

5827

5827

5827

5827

5827

5827

5827

5827

5827

5827

5827

5827

5827

5827

5827

5827

5827

5827

5827

5827

5827

5827

5827

5827

5827

5827

5827

5827

5827

5827

5827

5827

5827

5827

5827

5827

5827

5827

5827

5827

5827

5827

5827

5827

5827

5827

5827

5827

5827

5827

5827

5827

5827

5827

5827

5827

5827

5827

5827

5827

5827

5827

5827

5827

5827

5827

5827

5827

5827

5827

5827

5827

5827

5827

5827

5827

5827

5827

5827

5827

5827

5827

5827

5827

5827

5827

5827

5827

5827

5827

5827

5827

5827

5827

5827

5827

5827

5827

5827

5827

5827

5827

5827

5827

5827

5827

5827

5827

5827

5827

5827

5827

5827

5827

5827

5827

5827

5827

5827

5827

5827

5827

5827

5827

5827

5827

5827

5827

5827

5827

5827

5827

5827

5827

5827

5827

5827

5827

5827

5827

5827

5827

5827

5827

5827

5827

5827

5827

5827

5827

5827

5827

5827

5827

5827

5827

5827

5827

5827

5827

5827

5827

5827

5827

5827

5827

5827

5827

5827

5827

5827

5827

5827

5827

5827

5827

5827

5827

5827

5827

COMPANY 5  
MAP  
4

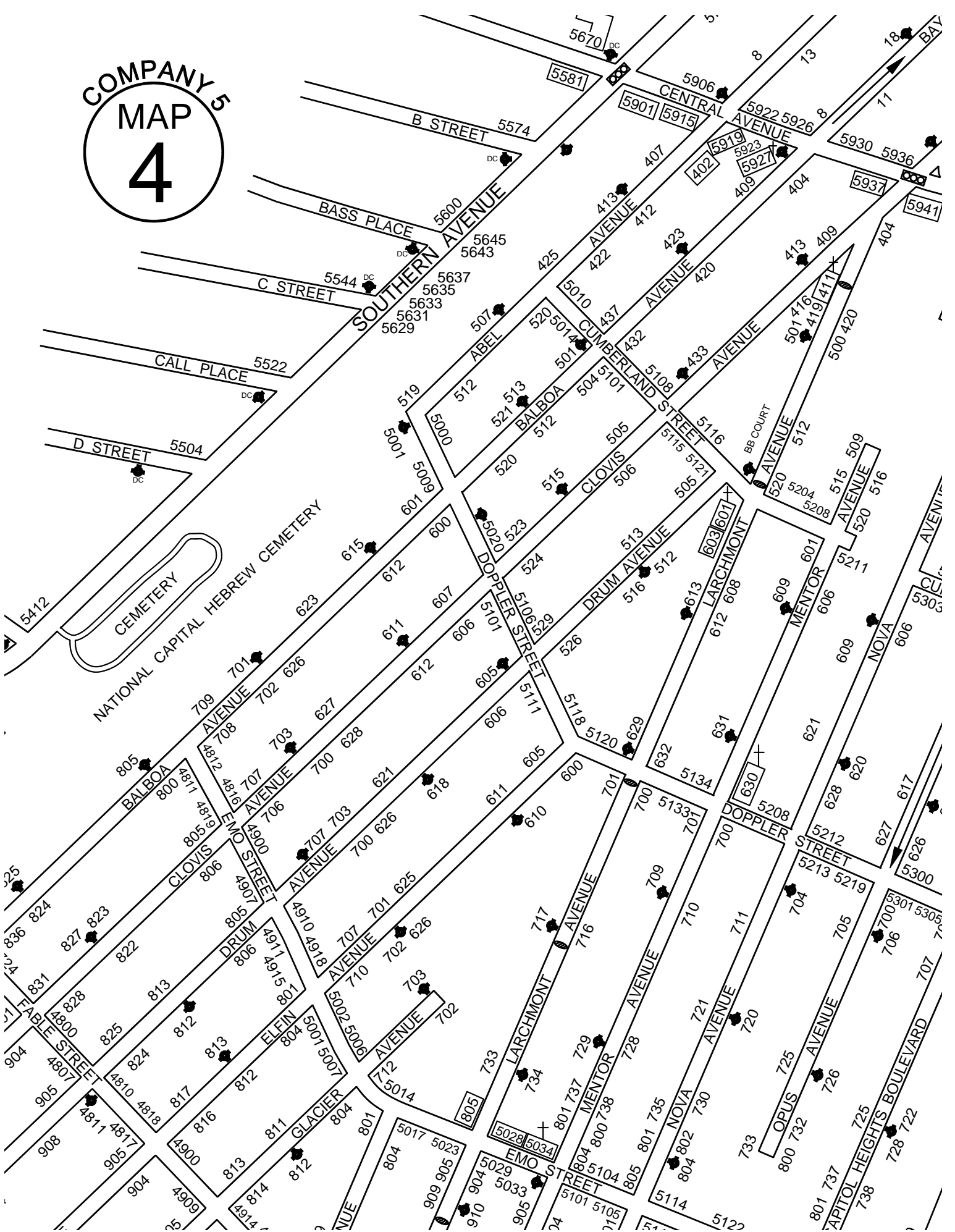

# MAP 5

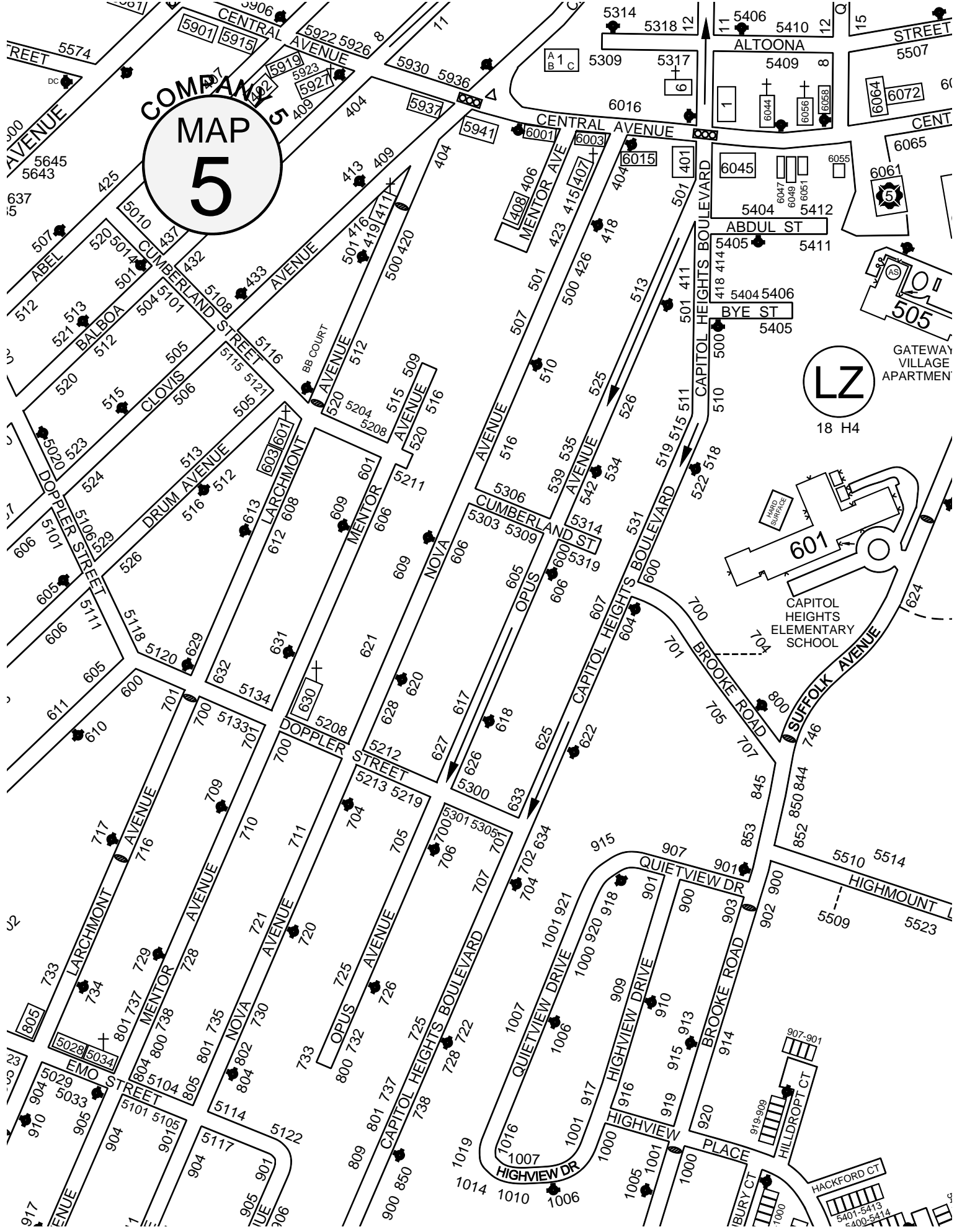

COMPANY 5  
MAP  
6

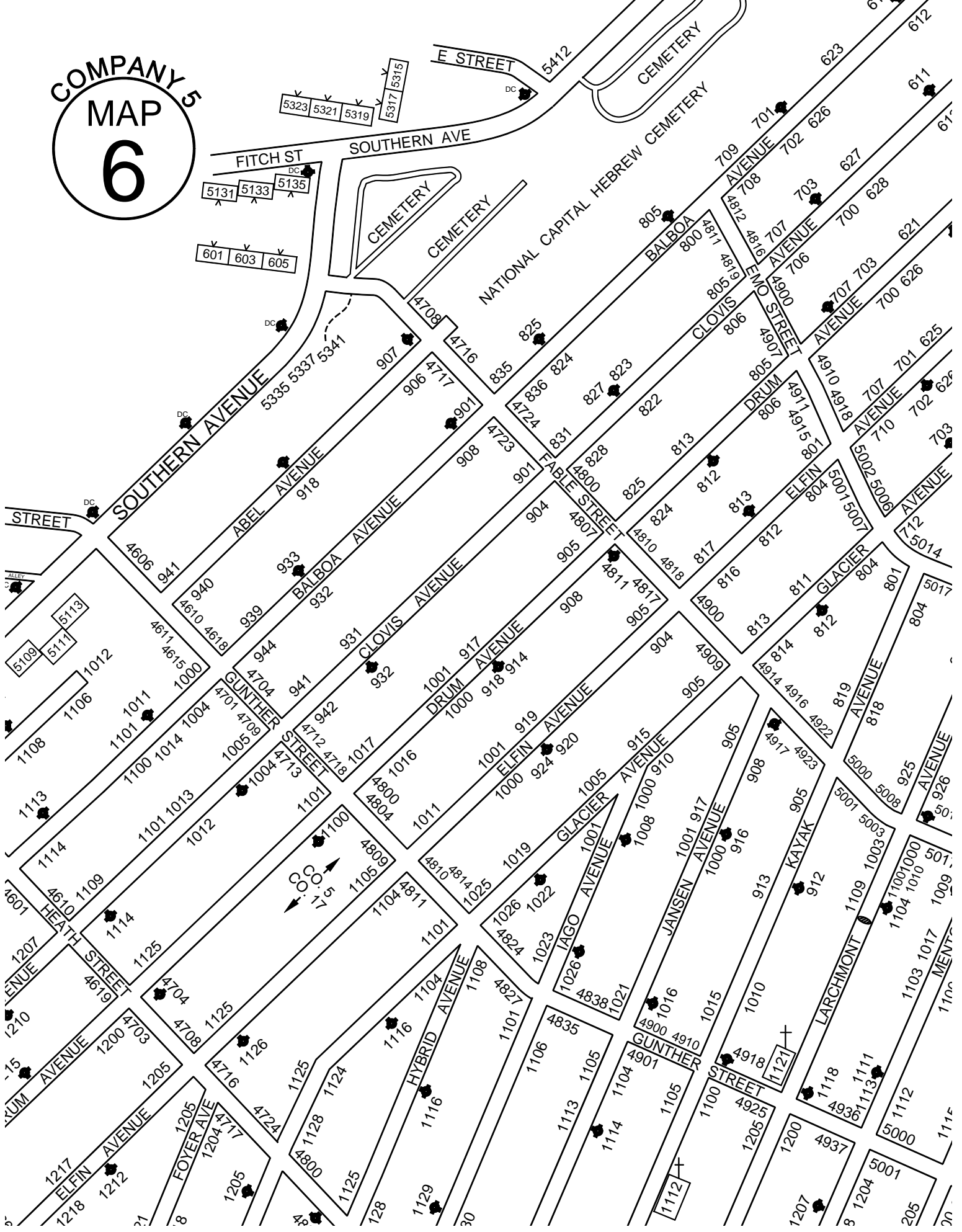



# MAP 8

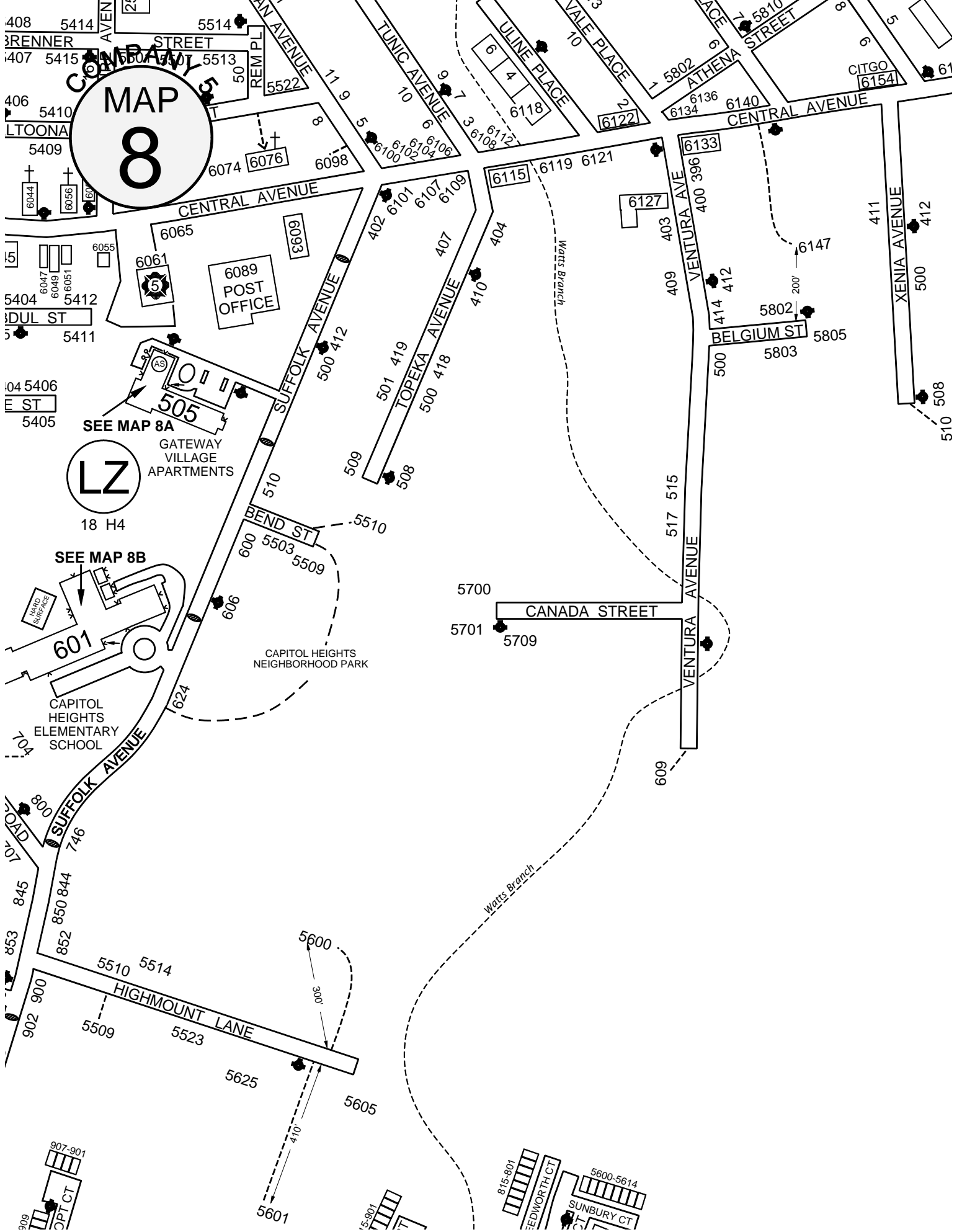

LZ  
18 H4

SEE MAP 8A

GATEWAY VILLAGE APARTMENTS

SEE MAP 8B

CAPITOL HEIGHTS ELEMENTARY SCHOOL

CAPITOL HEIGHTS NEIGHBORHOOD PARK

Watts Branch

Watts Branch



# COMPANY 5 MAP 10

LZ  
18 H5

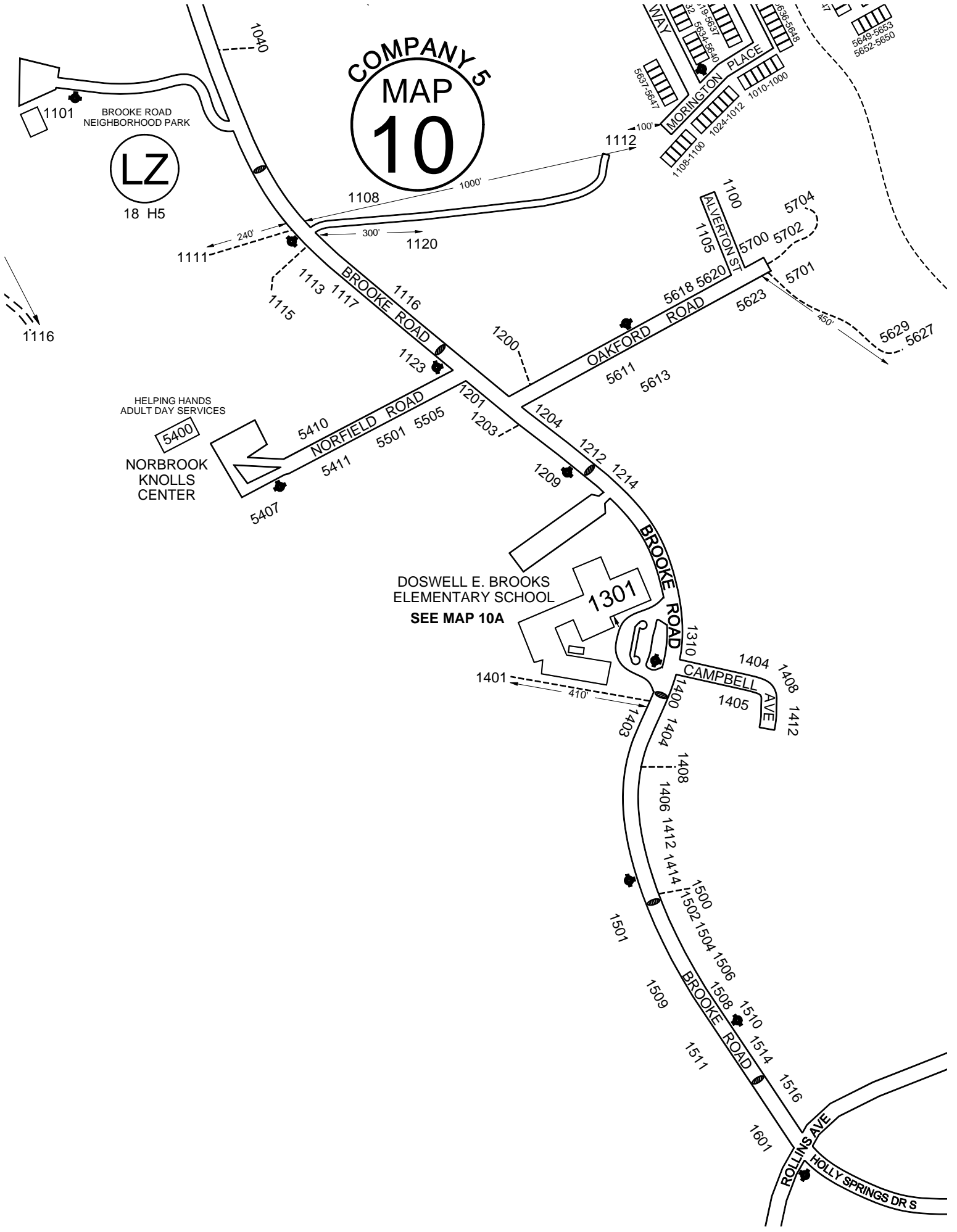

# EASTERN AVENUE APARTMENTS

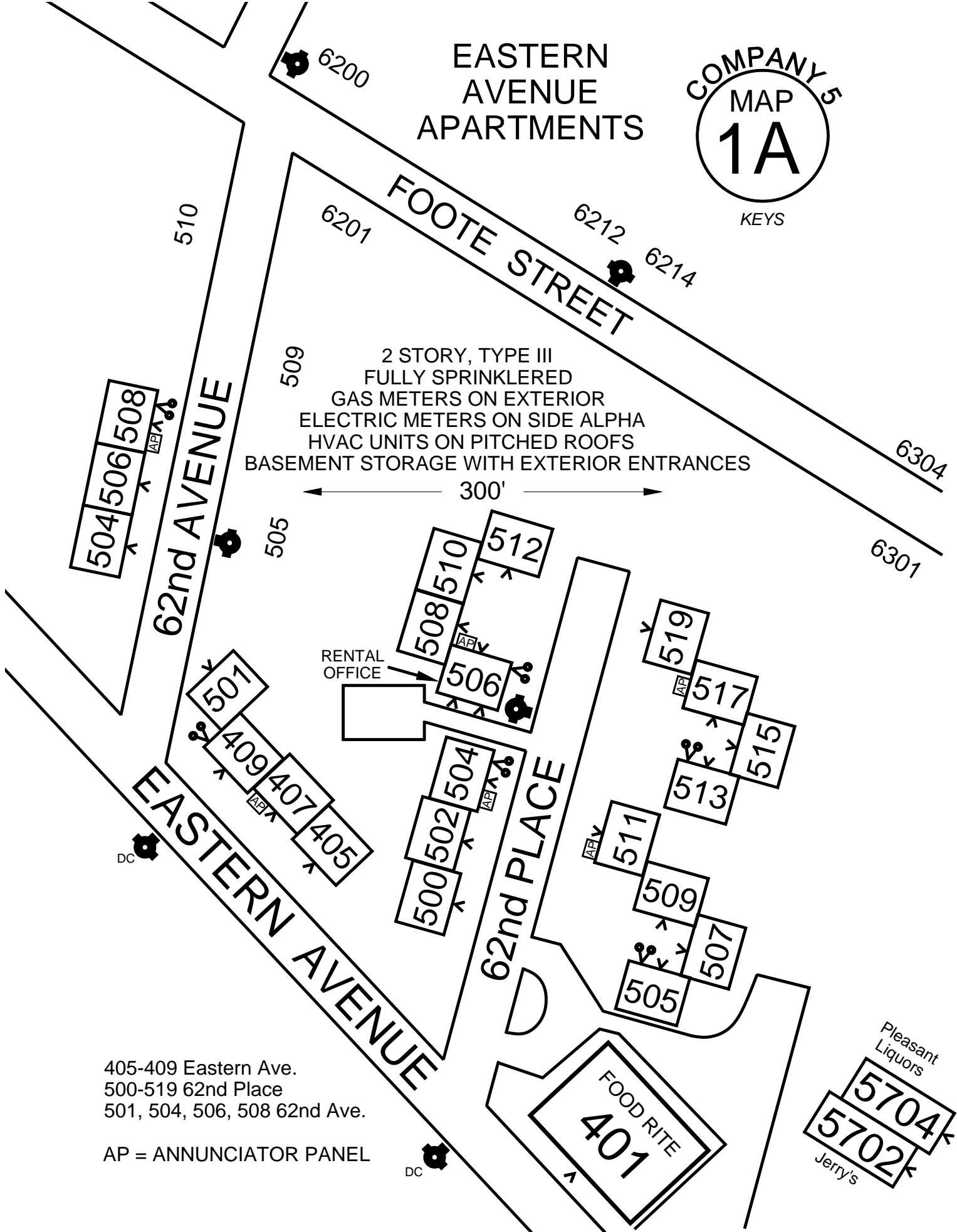

2 STORY, TYPE III  
 FULLY SPRINKLERED  
 GAS METERS ON EXTERIOR  
 ELECTRIC METERS ON SIDE ALPHA  
 HVAC UNITS ON PITCHED ROOFS  
 BASEMENT STORAGE WITH EXTERIOR ENTRANCES

← 300' →

405-409 Eastern Ave.  
 500-519 62nd Place  
 501, 504, 506, 508 62nd Ave.

AP = ANNUNCIATOR PANEL

Pleasant Liquors  
 5704  
 Jerry's  
 5702

FOOD RITE  
 401

# CAPITOL HEIGHTS METRO STATION

## 133 CAPITOL HEIGHTS BOULEVARD

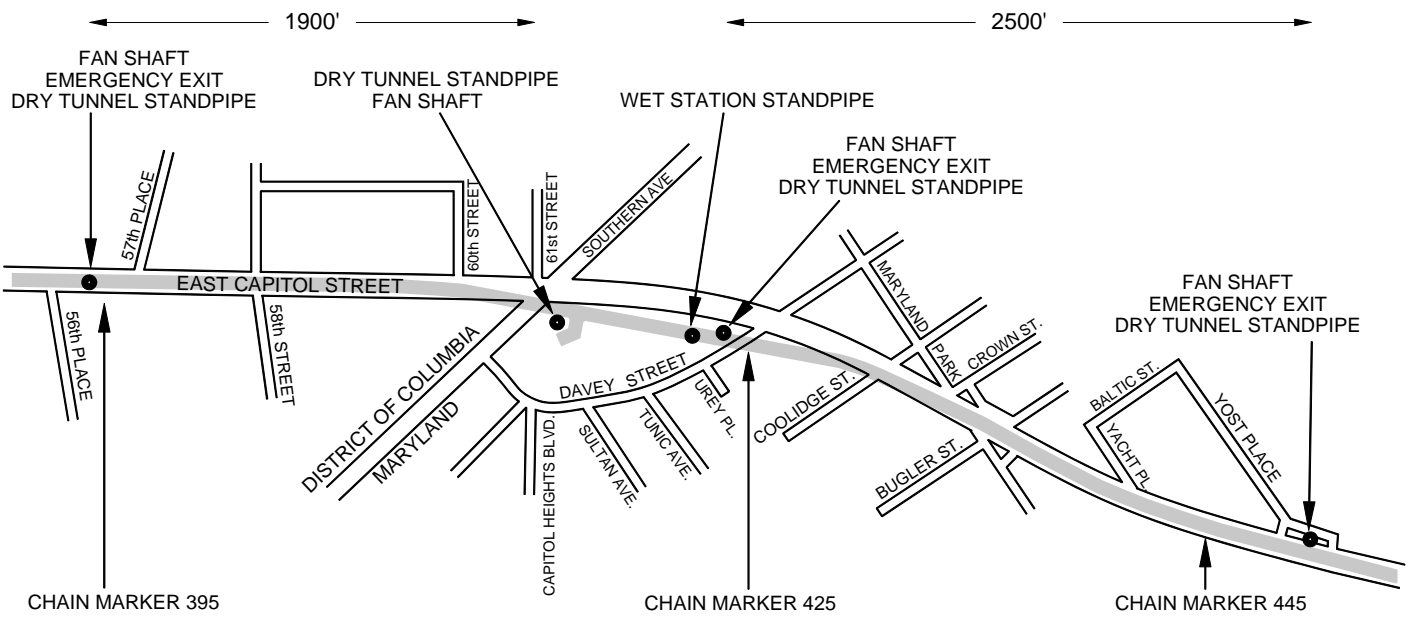
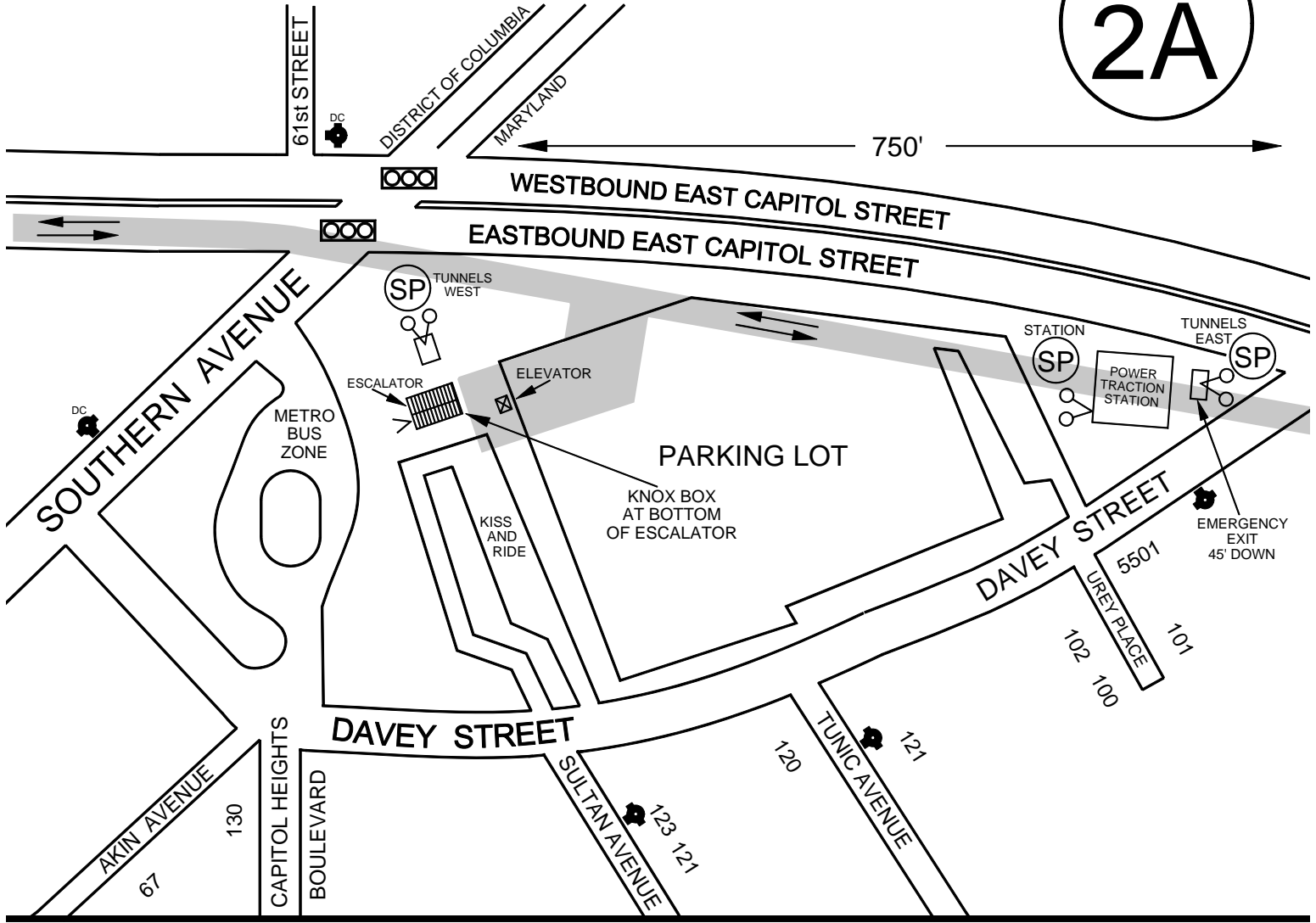

# MAP 2B

## Company 5

### STANDARD OPERATING PROCEDURES FOR METRO RAIL INCIDENTS INVOLVING CAPITOL HEIGHTS METRO STATION OR THE TUNNELS EAST AND WEST OF THE STATION

	<b>CAPITOL HEIGHTS METRO STATION OR WEST OF STATION IN TUNNEL</b>	<b>IN THE TUNNEL, BETWEEN CAPITOL HEIGHTS STATION AND YOST PLACE FAN SHAFT</b>
1 <sup>ST</sup> COMMAND OFFICER	Report to Metro Bus Zone. Establish Command on Channel 4	Report to Power Traction Station Establish Command on Channel 4
2 <sup>ND</sup> COMMAND OFFICER	Report to Power Traction Station.	Report to Yost Place Fan Shaft.
1 <sup>ST</sup> DUE ENGINE	Report to Metro Bus Zone. Report to Kiosk and initiate metro phone patch. Give size-up	Report to Metro Bus Zone. Report to Kiosk and initiate metro phone patch. Give size-up
2 <sup>ND</sup> DUE ENGINE	Report to Power Traction Station, reverse lay dual lines to hydrant at 5501 Davey Street. Charge wet station standpipe on side Delta, then charge the dry tunnel standpipe on side Bravo which covers East to Burgundy Street. Crew and equipment stage at emergency exit.	Report to Power Traction Station, reverse lay dual lines to hydrant at 5501 Davey Street. Charge wet station standpipe on side Delta, then charge the dry tunnel standpipe on side Bravo. Crew and equipment stage at emergency exit.
3 <sup>RD</sup> DUE ENGINE	Report to East Capitol Street and Southern Avenue. Charge dry tunnel standpipe. This supplies only 1 globe valve in tunnel to Southern Avenue. Crew and equipment stage at escalator.	Report to Fan Shaft at Yost Place and East Capitol Street. Charge the dry tunnel standpipe which covers West to Burgundy Street and East to Zelma Avenue. Give a size-up from Fan Shaft.
4 <sup>TH</sup> DUE ENGINE	Reverse lay from 3 <sup>RD</sup> engine to hydrant on Southern Avenue, near Davey Street. Supply 3 <sup>RD</sup> engine. Crew and equipment stage at escalator.	Report to Fan Shaft at Yost Place. Reverse lay dual lines to hydrant at 22 Yost Place and supply 3 <sup>RD</sup> engine. Crew and equipment stage at Fan Shaft.
1 <sup>ST</sup> DUE TRUCK	Report to Metro Bus Zone. Crew and equipment stage at escalator.	Report to Fan Shaft at Davey Street and East Capitol Street and prepare search efforts in outbound tunnel.
2 <sup>ND</sup> DUE TRUCK	Report to Power Traction Station. Crew and equipment stage at emergency exit.	Report to Fan Shaft at Yost Place and East Capitol Street and prepare search efforts in inbound tunnel.
RESCUE SQUAD	Report to escalators and establish Rapid Intervention Group.	Report to Power Traction Station and establish Rapid Intervention Group.
METRO SUPPORT UNIT	Report to Metro Bus Zone. Await directions from Command.	Report to Power Traction Station. Await directions from Command.
DISTRICT OF COLUMBIA UNITS	Report to 56 <sup>th</sup> Place Fan Shaft. Charge dry tunnel standpipe which covers tunnel East to Southern Avenue.	

# GATEWAY VILLAGE APARTMENTS

505 SUFFOLK AVENUE  
FOUR STORY, TYPE I, FULLY SPRINKLERED  
STANDPIPE RISERS IN EACH OF THREE STAIRWELLS



## SECOND THRU FOURTH FLOORS

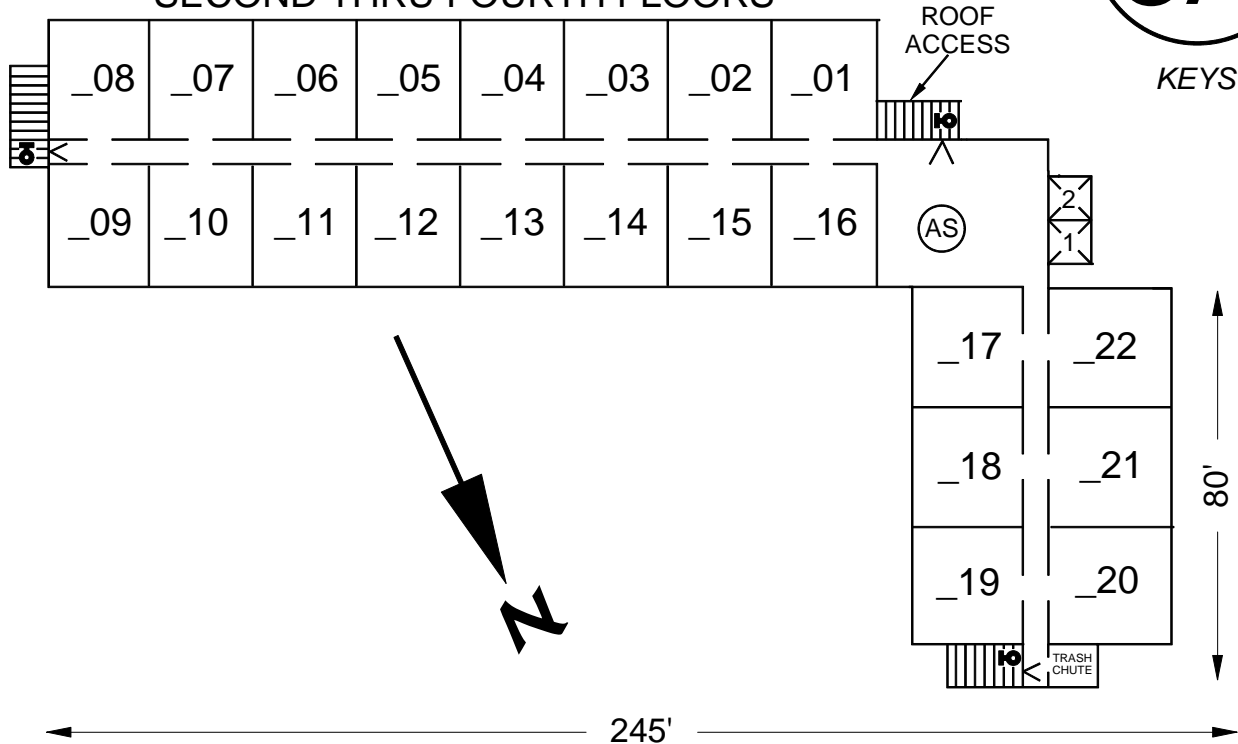

## FIRST FLOOR

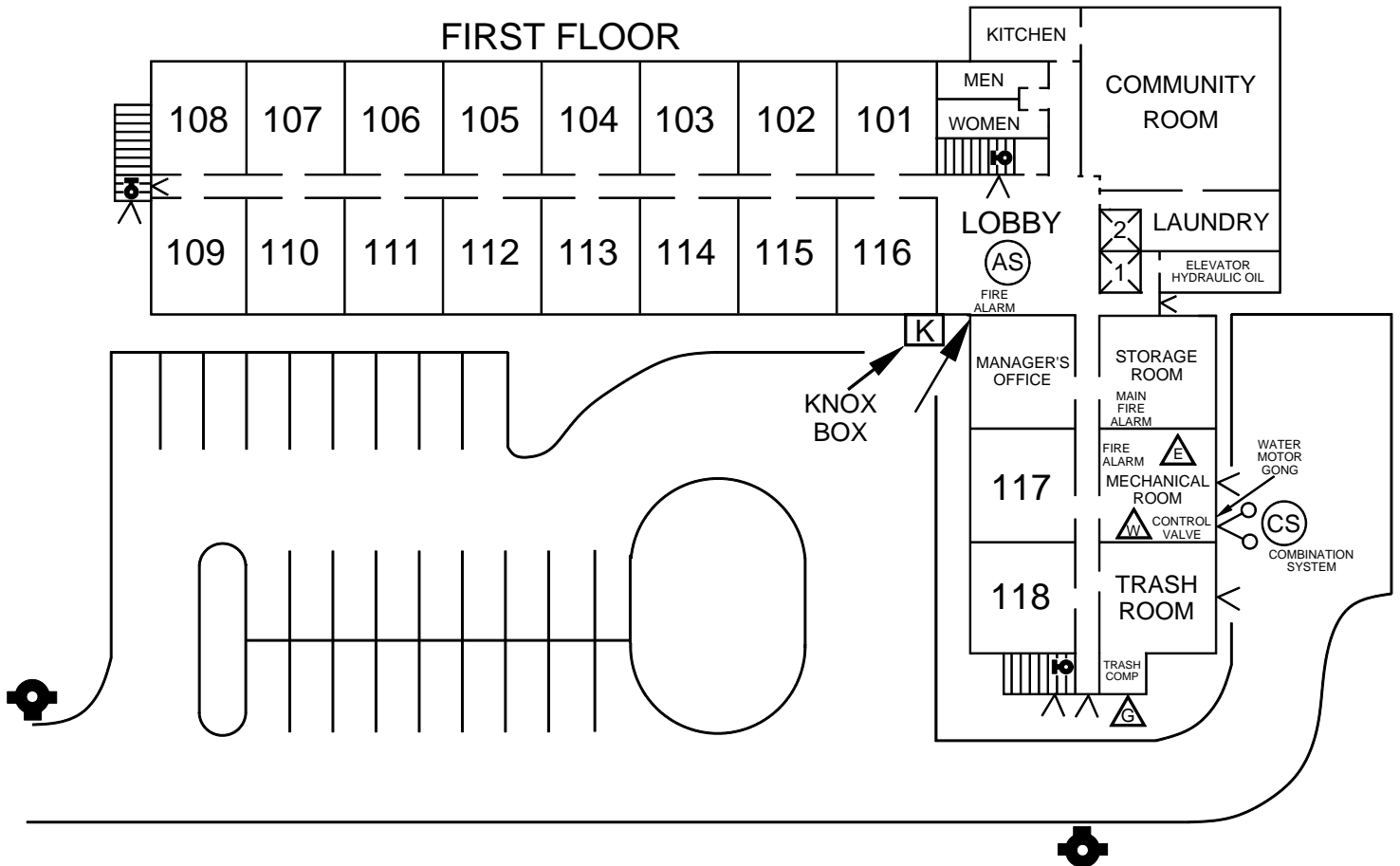

# CAPITOL HEIGHTS ELEMENTARY SCHOOL

601 SUFFOLK AVENUE

ONE STORY, TYPE II  
NON-SPRINKERED  
NO STANDPIPES

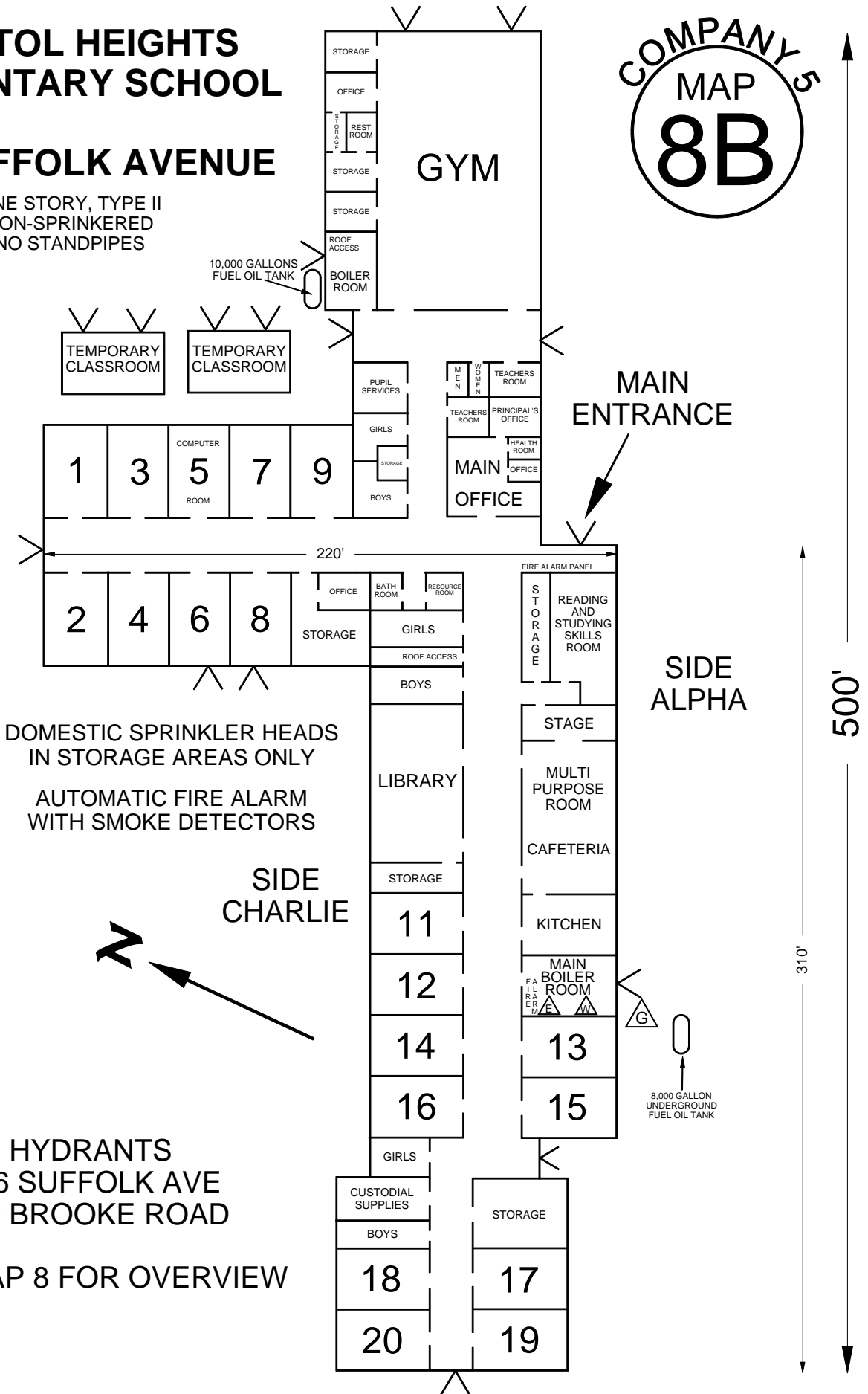

10,000 GALLONS  
FUEL OIL TANK

MAIN  
ENTRANCE

SIDE  
ALPHA

DOMESTIC SPRINKLER HEADS  
IN STORAGE AREAS ONLY  
AUTOMATIC FIRE ALARM  
WITH SMOKE DETECTORS

SIDE  
CHARLIE

HYDRANTS  
606 SUFFOLK AVE  
800 BROOKE ROAD

SEE MAP 8 FOR OVERVIEW

8,000 GALLON  
UNDERGROUND  
FUEL OIL TANK

500'

310'

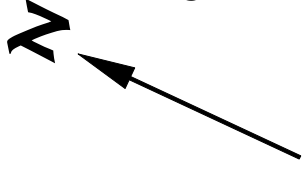

COMPANY 5  
MAP  
**9A**

← 300' →

**WINSOR VALLEY TOWNHOMES**

2 STORY WITH BASEMENT  
TYPE IV LIGHTWEIGHT CONSTRUCTION  
WOODEN I-BEAM FLOORING  
FULLY SPRINKLERED  
GAS METERS ON SIDE CHARLIE  
ELECTRIC METERS ON SIDE CHARLIE

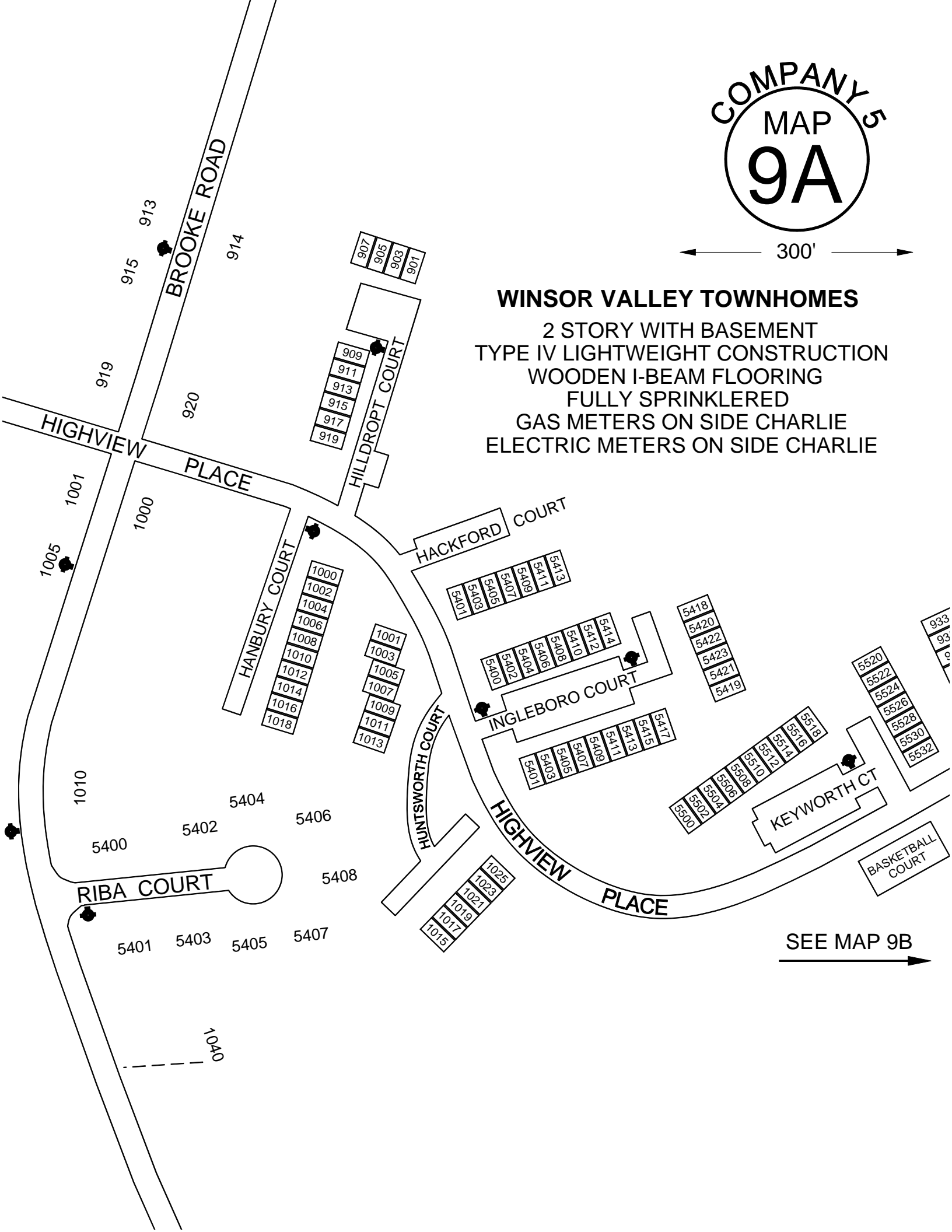

SEE MAP 9B  
→

COMPANY 5  
MAP  
**9B**

300'

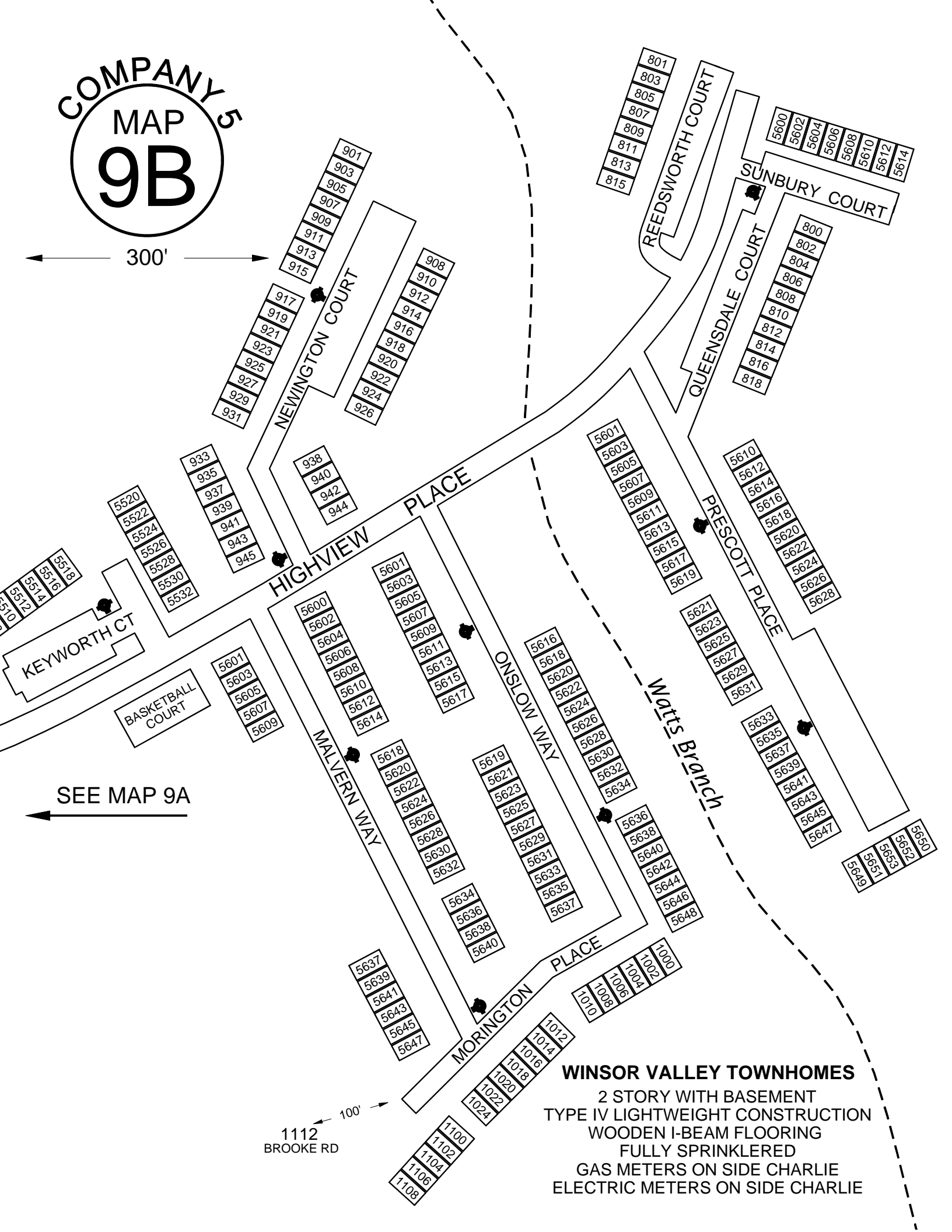

SEE MAP 9A

1112  
BROOKE RD

100'

**WINSOR VALLEY TOWNHOMES**

- 2 STORY WITH BASEMENT
- TYPE IV LIGHTWEIGHT CONSTRUCTION
- WOODEN I-BEAM FLOORING
- FULLY SPRINKLERED
- GAS METERS ON SIDE CHARLIE
- ELECTRIC METERS ON SIDE CHARLIE



# DOSWELL E. BROOKS ELEMENTARY SCHOOL

1301 BROOKE ROAD

ONE STORY, TYPE II  
NON-SPRINKLERED  
NO STANDPIPES

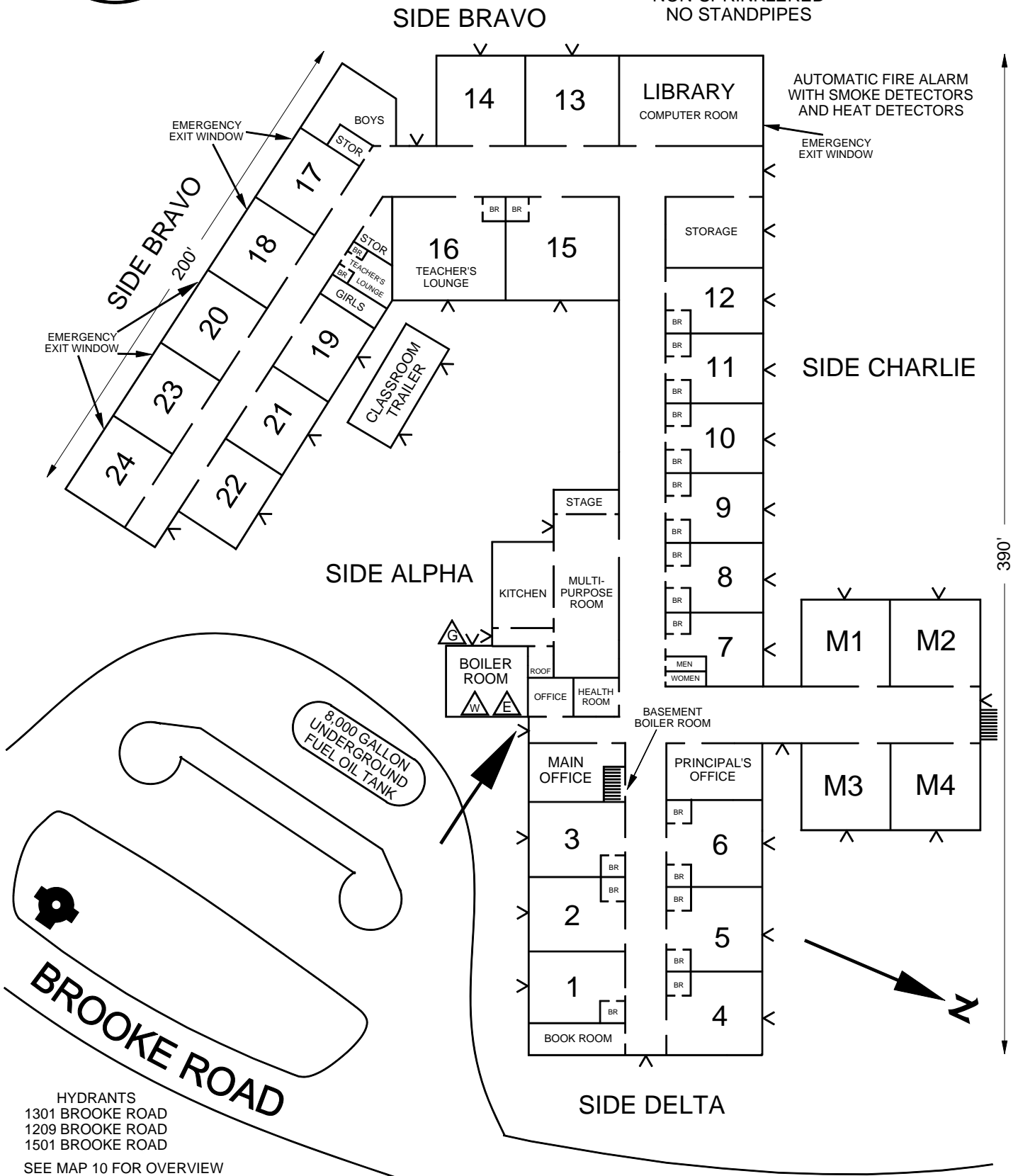

HYDRANTS  
1301 BROOKE ROAD  
1209 BROOKE ROAD  
1501 BROOKE ROAD  
SEE MAP 10 FOR OVERVIEW